

420 FLY



The Galeon 420 FLY offers one of the most spacious and well-designed interiors in its class. The stunning exterior follows the latest trends and will suit the tastes of both sport enthusiasts and more conservative clients. The exceptional flybridge comes fitted with a functional galley complete with a fridge and grill, a sizable sundeck and a rest and dining area for eight people.

Take full advantage of the extended stern platform that will handle most personal watercrafts for all your water based activities. The cockpit is separated from the saloon by the neatly folding door allowing for a vast open area on the main deck in a matter of seconds. Guests can enjoy a bright and functional interior complete with a dining area as well as a fully equipped galley, which can be moved down below for even more space in the saloon.

Below deck, three cabins with ample head room await the passengers. Two bathrooms, complete with showers ensure the comfort and privacy of all overnight guests. Highly customizable interiors with a choice of quality fabrics and fittings are sure to suit all tastes and requirements.

Select from a variety of engines and propulsion systems including the IPS, shaft and sterndrives to create your perfect combination and achieve the craft's full potential. With the Galeon 420 FLY find the space, style and sophistication you would expect from your next luxury yacht.

Flybridge line

The Galeon 420 FLY is considered by many to be a benchmark all other flybridge models may be measured by. It offers an incredible amount of space on all three decks, several layout options, powerful engines and countless customization possibilities.





420 FLY

The modern and functional exterior has made the 420 FLY extremely popular over the years



The 420 FLY handles well even during difficult manoeuvring



A hydraulic bath platform is available



420 FLY - Walnut

A spacious saloon with an entertainment area, helm and galley



Double seats at the helm —



An extra rest area with a pop-up TV —



Great visibility and all controls handy —



Galley is moved forward in this configuration —



420 FLY - Walnut

The owner's cabin is moved forward and has private access to the bathroom



Three incredible cabins down below —



Twin guest cabin —



Twin beds can be made into a double —



One of the two bathrooms down below —



— All controls are available on top deck



— A very spacious flybridge



— Glass door opens all the way to reveal the interior



— Two sun pads on the bow

420 FLY

THE NEXT GENERATION

LAYOUTS

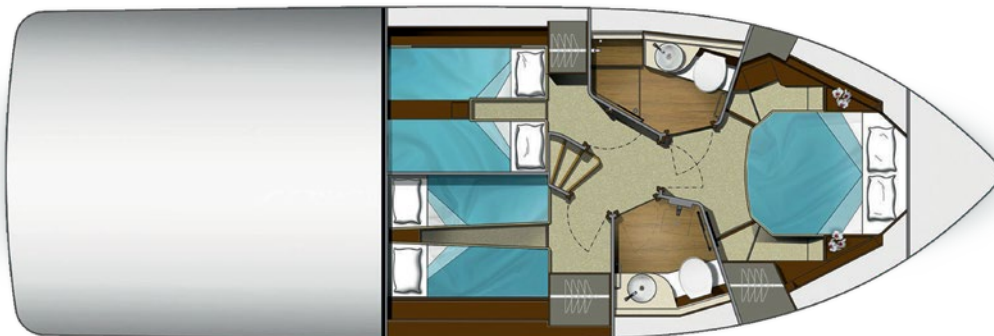
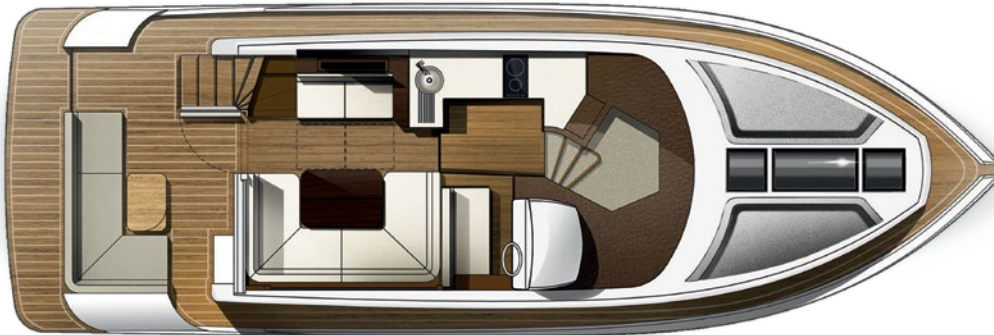
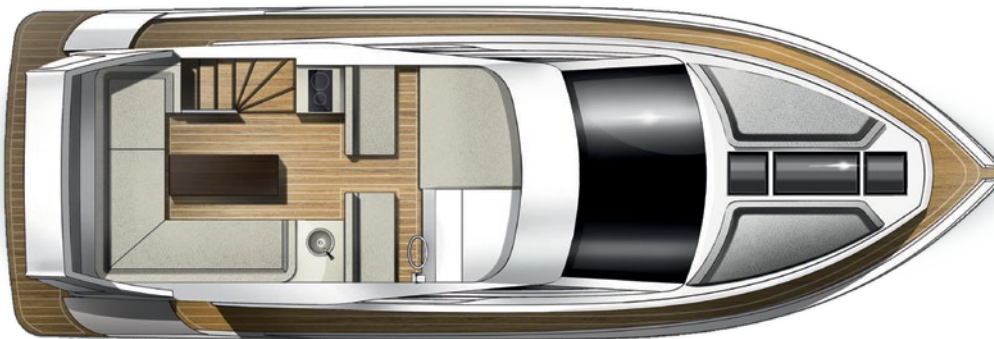

TECHNICAL SPECIFICATION

Length of the hull	[m]	11.79
Length overall	[m]	12,50 / 13.25*
Beam of the hull	[m]	4.10
Beam overall	[m]	4.16
Draft max ₁	[m]	0.80
Bridge clearance ₂	[m]	4.40
Height to transport	[m]	5.15
Fuel tank capacity	[dm ³]	2 x 550
Water tank capacity	[dm ³]	450
Grey water tank	[dm ³]	200
Black water tank	[dm ³]	150
Mass of Light Craft Condition ₃	[kg]	12070
Maximum Load	[kg]	2740
Min. engine (-s) power	[kW/hp]	2 x 198 / 270
Max. engine (-s) power	[kW/hp]	2 x 353 / 480
Crew limit		12
Category		B

₁ - without propellers ₂ - Max. height from water line at draft min. ₃ - minimum mass with base engines
* - with extended stern platform

3RD GALEON GENERATION

TONY CASTRO
DESIGN & NAVAL ARCHITECTURE

VOLVO PENTA



SEAKEEPER 6