

# 470 SKYDECK



The 470 SKYDECK can be fitted with all the amazing innovations of the 500 series in a more compact package. With bespoke interiors, great performance and handling it is sure to please all yacht enthusiasts. This daring, new design clearly shows the bold path Galeon has taken to propel its yachts into the future. Once again fitted with an automatic bow settee area that swiftly morphs into a sundeck, a cockpit roto-seat, and everyone's favorite feature - the Beach Mode, be sure the 470 SKYDECK will make the most of the space available on board.

Inside, find yourself in a world of luxury with a quality finish all Galeon yachts are known for. Customize the interior with a variety of available woodwork and fabrics and select from a wide range of available options and equipment to truly make it your own.

Guests can be entertained on the main deck that features a dining area and a full-sized kitchen or take respite down below in one of the three cabins. The spacious master is located midship and offers access to an en suite bathroom for extra privacy.

Several engine options and propulsion types, including the IPS drives allow to strike a perfect balance between great fuel economy and sporty performance. The yacht joins the already extensive lineup of Third Generation units available and is sure to make a long-lasting impression with its unique combination of substance and style.

The 470 SKYDECK shows innovation and maps a new direction for modular luxury crafts.

The new 470 SKYDECK was developed to mirror the incredible features of its twin 460 FLY model while offering a more sporty and dynamic design with the ability to close off the top deck.









— Notice the sporty line of the Skydeck and a high volume of windows





Great handling of the sport-oriented 470 model



Various cockpit options are available including a roto-seat







# 470 SKY

## Beach Mode

The 470 can be fitted with the incredible Beach Mode, a cockpit roto-seat and a transformable bow rest area - impressive!



The Bow rest area offers proper seats with back support!



Increase the functionality with the innovative Beach Mode option





## 470 SKY - Lati Grey

A bright and welcoming interior shows attention to detail





A well equipped galley is moved back



The large windows slide forward opening up the interior!



The dinette and rest area, notice the large sunroof above



Take control of the yacht from the helm on the main deck





470 **SKY** - Lati Grey

A large owner's cabin is located midship





The owner's cabin offers a private bathroom for comfort —



The forward VIP cabin with skylights above —



Bunk beds in the guest bedroom —



Two bathrooms are located below deck —









GALEON

470 SKY

Limited Edition

*Limited Edition*

470 **SKYDECK**

**DARK EUCALYPTUS**





— The huge windows offer extraordinary views more typically associated with a larger yacht



— The interior reflect the level of detail precision



— The spacious bow cabin offers plenty of storage space



— The bathroom includes high quality accessories



*Limited Edition*

# 470 SKYDECK

DARK EUCALYPTUS







— Quickly close off the top deck when not in use - genius!



— Prop-up table in the bow rest area



— Beach Mode and easy access to the top deck



— A large cockpit can also fit a 360° rotating sofa



# 470 SKYDECK

## NEXT IN LINE

### LAYOUTS

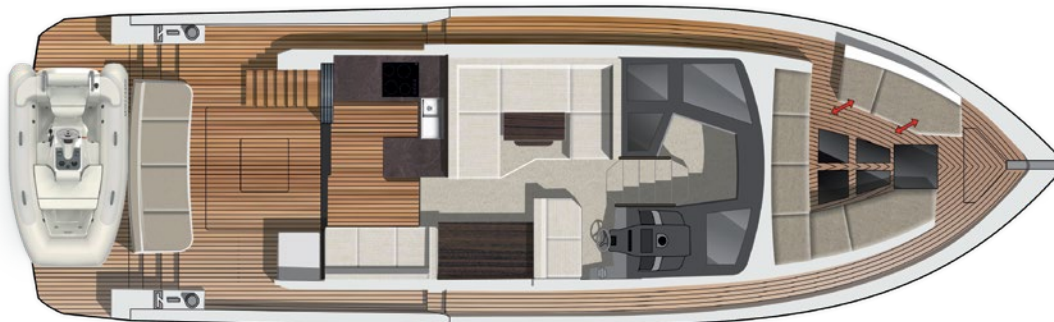
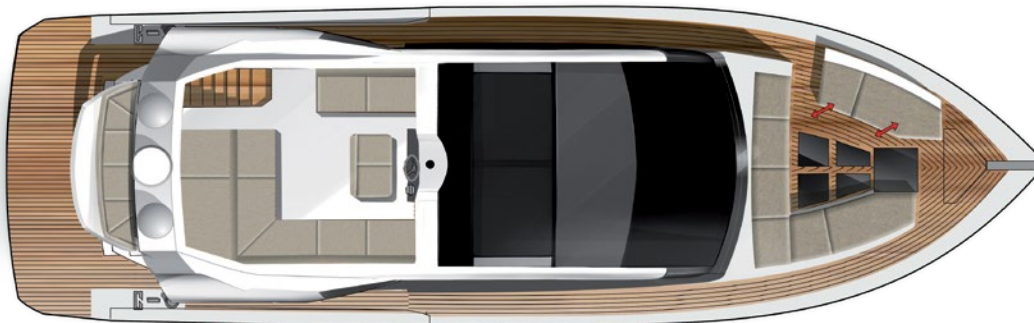

### TECHNICAL SPECIFICATION

Length of the hull	[m]	12.90
Length overall	[m]	14.35
Beam of the hull	[m]	4.33
Beam overall	[m]	4,37 / 5,66 <sub>4</sub>
Draft max <sub>1</sub>	[m]	0.90
Bridge clearance <sub>2</sub>	[m]	4.83
Height to transport	[m]	4,33
Fuel tank capacity	[dm <sup>3</sup> ]	2 x 750
Water tank capacity	[dm <sup>3</sup> ]	650
Grey water tank	[dm <sup>3</sup> ]	350
Black water tank	[dm <sup>3</sup> ]	200
Mass of Light Craft Condition <sub>3</sub>	[kg]	16000
Maximum Load	[kg]	3950
Min. engine (-s) power	[kW/hp]	2 x 324 / 440
Max. engine (-s) power	[kW/hp]	2 x 441 / 600
Crew limit		12
Category		B

<sub>1</sub> - without propellers    <sub>2</sub> - Max. height from water line at draft min.    <sub>3</sub> - minimum mass with base engines

3<sup>RD</sup> GALEON  
GENERATION

TONY CASTRO  
DESIGN & NAVAL ARCHITECTURE

VOLVO  
PENTA







# 470 SKYDECK







## NEXT IN LINE

---

