

435 ^{GTO}



propulsion

TRIPLE MERCURY VERADOS

	cruising speed*	maximum speed*
Triple-600 HP	40 MPH	55 MPH

*The listed performance data is an estimate only based on vessel testing on fresh water with 6 people, full fuel and water and a clean hull bottom. The performance will change based on boating location, vessel loading and maintenance.

length overall	44' 9" / 13.65 M
hull length	41' 2" / 12.55 M
beam (normal)	13' 6" / 4.15 M
beam (balconies down)	19' 5" / 5.91 M
dry weight	35,314 LB / 16,018 KG (est)
maximum load weight	8,117 LB / 3,682 KG (est)
draft max.	3' 9" / 1.18 M
transport height	14' / 4.29 M
fuel capacity (gas)	528 GAL / 2000 L
water capacity	79 GAL / 300 L
black water capacity	26 GAL / 100 L
grey water capacity	39 GAL / 150 L

The specification measurements are approximate and subject to variance.

GALEON
YACHTS
galeonyachts.us

GTO

The Galeon 435 GTO is the next-in-line of powerful, outboard models with its sleek contours and versatile space distribution on board, bound to stand out in any marina. The silhouette is a clear evolution of the acclaimed 375 GTO with even more aggressive lines and eye-catching details fitted onto the two-tone exterior. The striking side profile features full-length hull windows and partially glazed balconies, while the wheelhouse has unobstructed, 360° views.



Immerse yourself in a sleek and modern helm inspired by high-performance sports cars with a luxurious feel.

Note: Layout and features may vary from shown here due to manufacturer consideration and client customization.



Have more space to stretch out and enjoy hovering above the water in Beach Mode



The forward cabin feels like that of a much larger Galeon yacht, plenty of natural light with best in class head.

435 GTO

STANDARD FEATURES

EXTERIOR

Exterior Color & Upholstery

- Exterior color
- Silver & Grey

Hull & Deck Accessories

- Cleats, stainless steel
- Flooring, molded non-skid
- Horn, electric
- Lights, navigation
- Mooring system
- Reversible electric anchor winch
 - Anchor roller
 - Galvanized anchor and chain
 - Fiberglass deck hatch to self-draining chain locker
- Radar mast, stainless steel
- Rubrail, PVC with stainless steel insert
- Searchlight, remote-controlled
- Thru-hull fittings, stainless steel/bronze
- Windshield, tempered glass

Cockpit

- Air conditioning vents at helm
- Cupholders
- Door, cabin entrance – sliding and lockable, plexiglass
- Handrails, 316 stainless steel
- Hardtop, fiberglass
- Helm Station
- Console rail, stainless steel
- Compass
- Helm seat, captain's chairs with bolster
- Forced air vents above helm
- Station instruments and controls
- Digital gauges
 - Switches
 - Alarm, High Water – bilge
 - Start keys, 3 position
 - Dual Lever Control, EVC
 - Joystick Piloting with SkyHook and Auto Pilot
 - Trim tab control panel
 - Outlet, USB

- Steering wheel, adjustable
- Stereo remote control
- Windscreen wiper with front window washing system
- Lighting, indirect LED
- Lighting, direct LED
- Outlet, 120V GFI
- Self-draining
- Seating with table (fiberglass)
- Speakers
- Storage, side lockers
- Wet bar with sink, electric grill, and trash bin
- Refrigerator

Galley

- Ambient LED lights
- Corian countertops
- Sink, chrome faucet and Corian cover
- Light, overhead LED
- Microwave, 120V
- Outlet, 120V GFI protected
- Refrigerator, 120V with freezer compartment
- Storage, cabinets with overhead cupboard

Stern

- Cleats, stainless steel retractable
- Doors
- Lighting, indirect LED
- Shore power inlet, dual 120V/30A
- Shore water connection

INTERIOR

Interior Color & Materials

- Cabinetry
- Beachwood grey
- Wood Flooring
- Matching cabinetry selection
- Interior upholstery
- Grey

Forward Cabin

- Carbon monoxide detector
- Lighting, overhead LED

- Outlet with USB, 120V
- Storage, wall cupboards
- Wooden floor
- Berth, polyurethane high resilience foam mattress and bed covers
- Lighting, overhead LED
- Outlets, 120V (adjacent to bed)
- A/C Vent

Aft Cabin

- Carbon monoxide detector
- Ambient LED lights
- Floor, carpet
- Lighting, accent LED
- Lighting, overhead LED
- Outlets, 120V
- Storage, port and starboard

Head

- Door access to head with mirror
- Bathroom accessories – toothbrush holder, towel hooks, soap dispenser, toilet paper holder
- Cabinets, mirrored
- Corian countertop with bowl and chrome faucet
- Extractor fan
- Flooring, molded non-slip
- Lighting, overhead LED
- Outlet, 120V GFI Protected

SYSTEMS

Power & Drive Systems

- Mercury Verado 3x 600 HP outboard engines
- Stainless Steel Propellers
- Electro-hydraulic steering system
- Contra-rotating props
- Trim tabs

Bilge

- Bilge pumps, automatic electric (2) – forward and aft
- Bilge pumps, high water alarm
- Common drain system

Air Conditioning

- Air Conditioning with reverse cycle heating, Dometic MarineAir (56,000) BTU with dual control for interior and helm
- DC Electrical System (12V)
- Batteries
 - Battery charger
 - Circuit Breakers
 - DC Main Switchboard
- AC Electrical System (120V)
- Shore power, single 120V/50A
 - AC main switchboard
 - Generator, 12kW with sound shield

Fuel System

- Fuel tank, vented
- Fuel filters, 3 engines
- Fuel lines
- Fuel inlet
- Fuel stop valve
- Diesel Fuel tank, vented
- Diesel Fuel filters, 1 generator
- Diesel Fuel lines
- Diesel Fuel inlet
- Diesel Fuel stop valve

Fresh Water System

- Water tank stainless steel, vented
- Water inlet, stainless steel
- Water pump, automatic with filter
- Dockside/shore water connection
- Level indicator

Waste Water System

- Black Water Waste System
- Waste tank, stainless steel with odor filter, water level sensor, vented
 - Waste pump, electric
 - Level indicator and pump switch
 - Dockside pumpout fitting – stainless steel
 - Overboard waste discharge fitting

OTHER ITEMS

- Owner's manual and engine manual

GTO

Layouts

FACTORY OPTIONS

Comfort Pack

- Cablemaster
- Cover for foredeck seating
- Cover for aft seating
- Raymarine Chartplotter/FF, 1x Axiom 16 xl RV-US
 - CP370 Transducer
 - Radar, Quantum Q24C 18"
- Additional Raymarine Chartplotter, 1x Axiom 16 xl [each, max 3 x 16"]
- Raymarine VHF RAY91 AIS and VHF Antenna
- Sunshade awning in cockpit

Luxury Pack

- Refrigerator in galley portside lower deck
- Microwave (230V)
- Upgraded Fusion sound system with 2 amplifiers, 8 speakers, 1 subwoofer/stereo remote
- LED underwater lights 3/4 aft and 4 side, blue/white (7/8pcs)
- TV LED 40" in front cabin
- TV LED 32" in aft cabin
- White and blue LED lights (cockpit, gate passage, lounge area)
- Chain counter display

Individual Options

- Seakeeper 5
- Carbon Aft Sundeck Package
- Raymarine Cyclone 3ft open array radar
- Ice maker in cockpit
- Electric roof in salon with tinted glass
- Electric upper door for side passage with tinted glass
- Electric openable side windows on both sides
- Stainless steel anchor and chain

Colors and Materials

- Cabinetry
 - Gloss or Matte Walnut with matching floor
 - or
 - Gloss or Matte Eucalyptus with matching floor

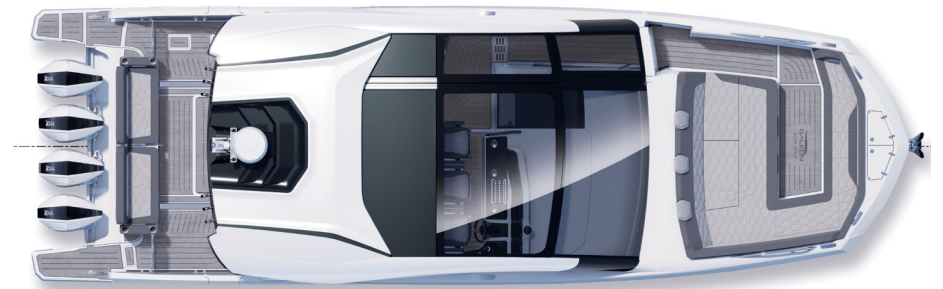

MAIN DECK

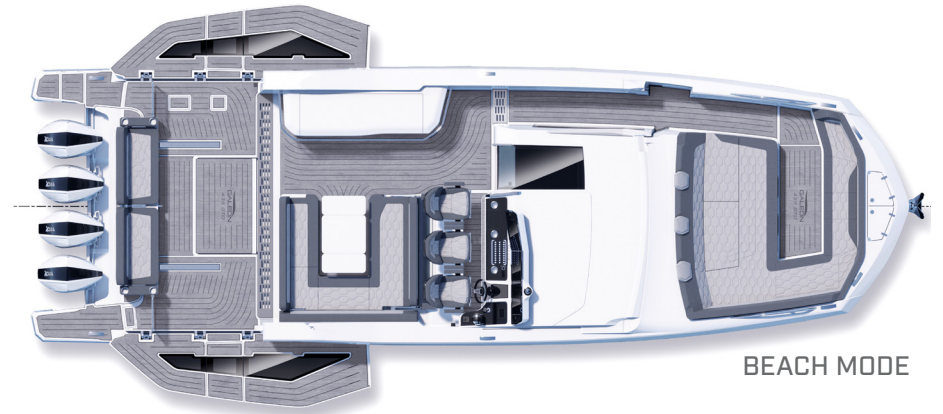

BEACH MODE

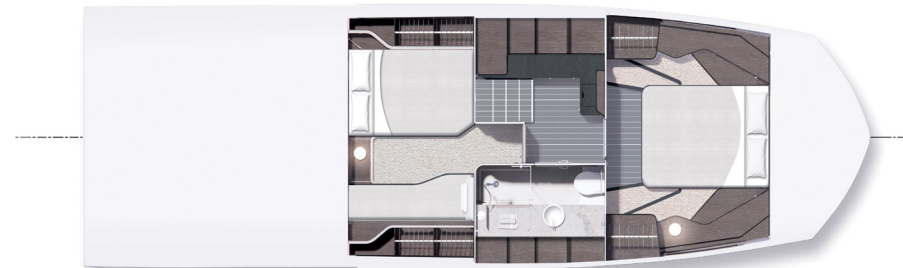

BELOW DECK

**The listed performance data is an estimate only based on vessel testing on fresh water with 6 people, full fuel and water and a clean hull bottom. The performance will change based on boating location, vessel loading and maintenance.*